

TURKU 2

Installation drawings



marking			length	pcs				
	SCREW 3,0x40 A2 STAINLESS FOR MOULDINGS			100				
	SCREW 4,8x90 A2 STAINLESS FOR WALL CONNECTIONS (CORNERS)			300				
	SCREW 3,5x50 AW20 FOR FLOOR BOARDS			100				
	SCREW 4,5x70 FOR ROOF EDGE AND BENCH SUPPORTS			100				
	SCREW 5,0x90 FOR FLOOR FRAME AND WALL CONNECTIONS			100				
	SCREW 5,0x120 FOR WALL CONNECTIONS			25				
	SCREW 6,0x180 FOR ROOF RAFTERS AND WALL CONNECTIONS			25				
	NAIL 75 MM FOR ROOF BOARD			~300				
	NAIL 40 MM FOR CEILING BOARD			~300				
	SCREW 4,8x40 FOR L-IRON			40				
LB-1	L-IRON 40x40x40 FOR CEILING BEAM			6				

40x146 wall logs

	extra	1 tk	
	01	2 tk	
	02	2 tk	
	03	40 tk	
	03A	2 tk	
	03C	2 tk	
	04C	2 tk	
	05	28 tk	
	06C	2 tk	
	07	8 tk	

TURKU2

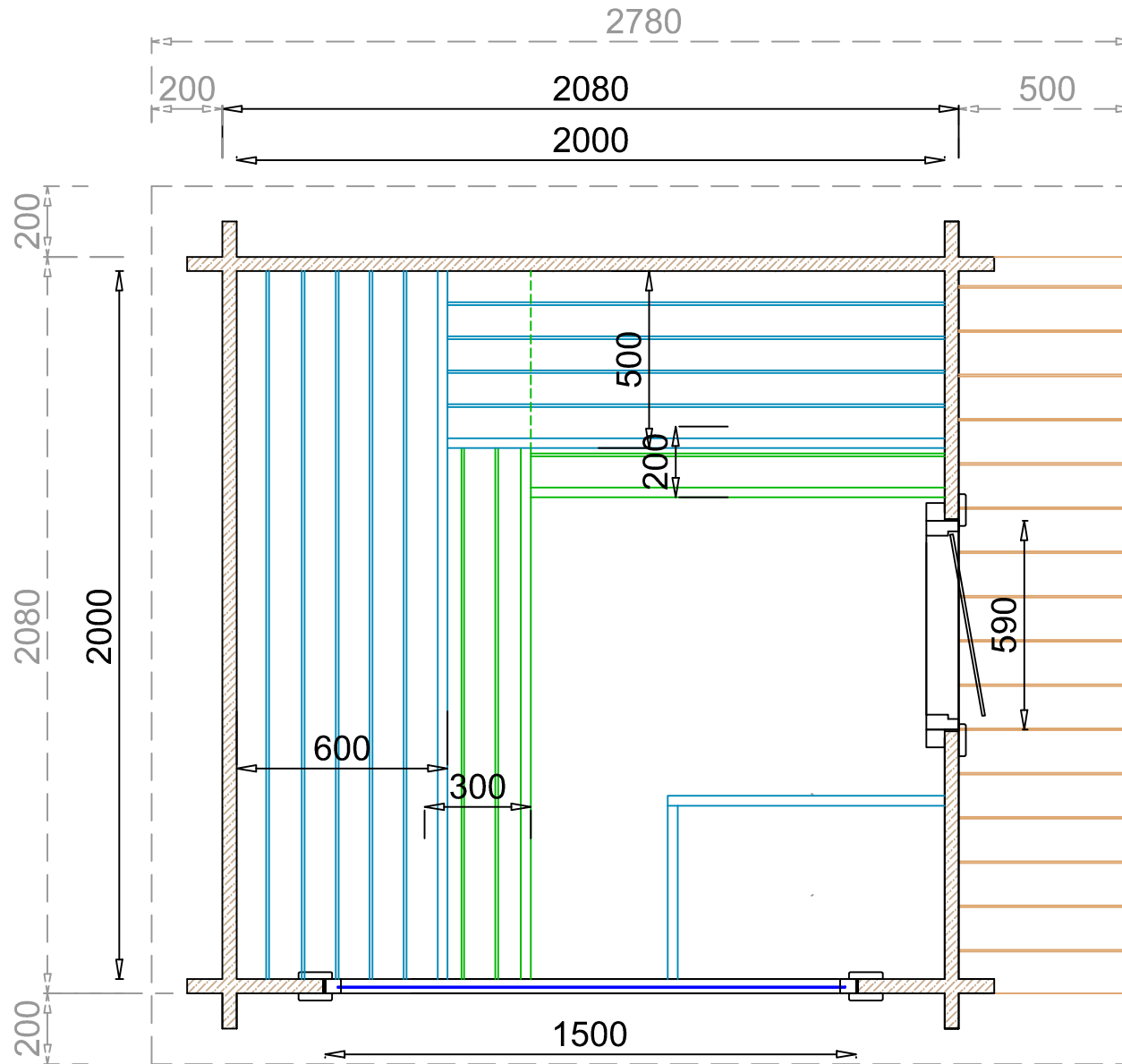

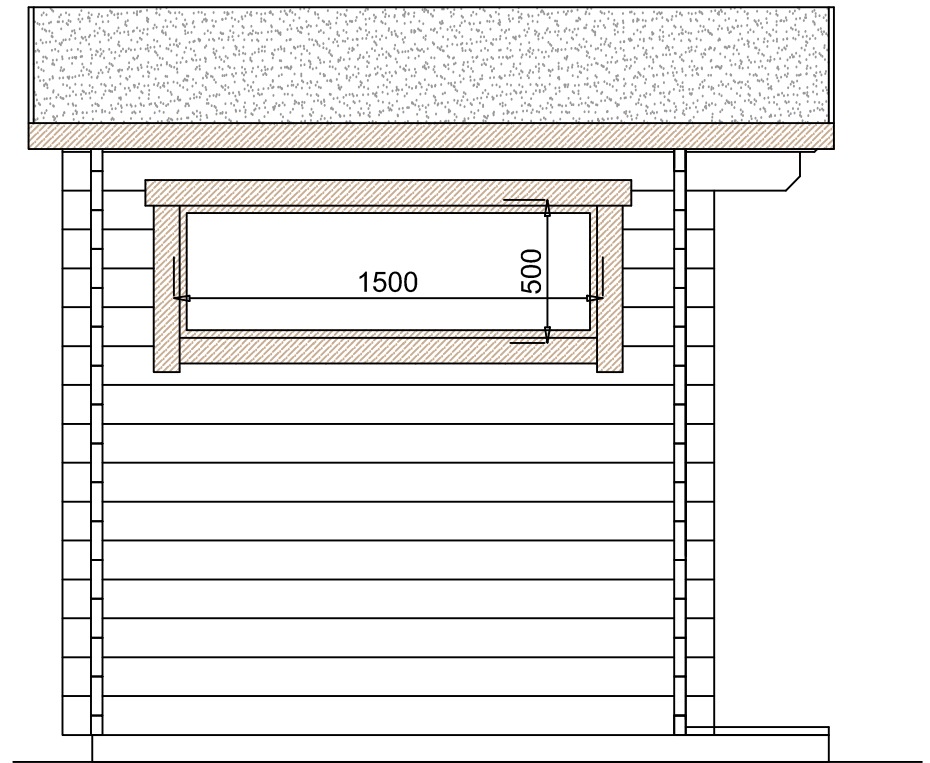
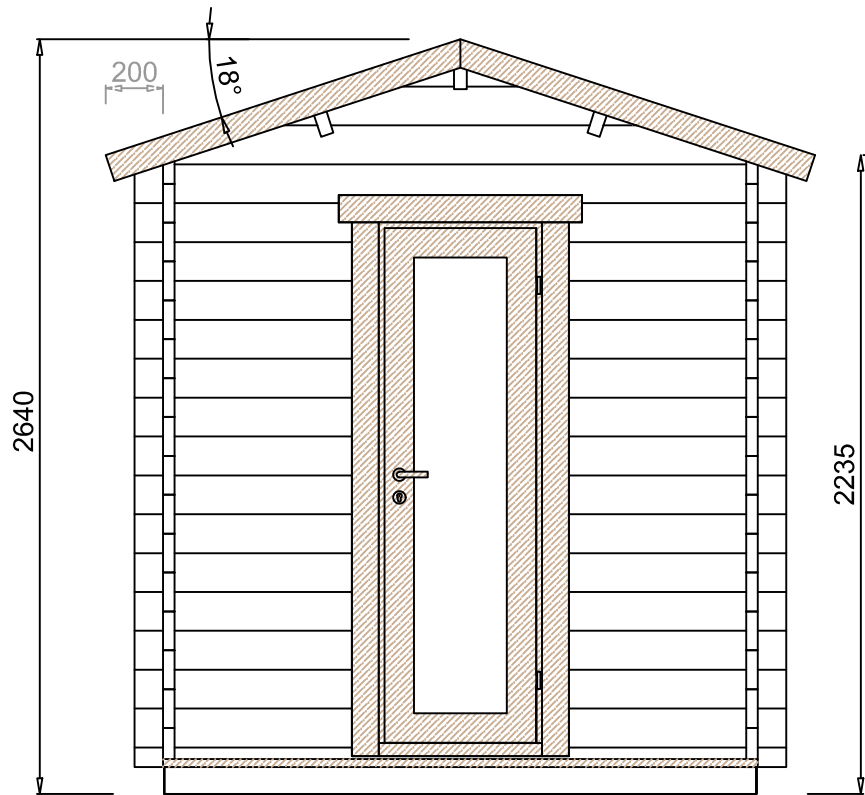

Halden XS

BASEMENT POSITIONING

OPTION A

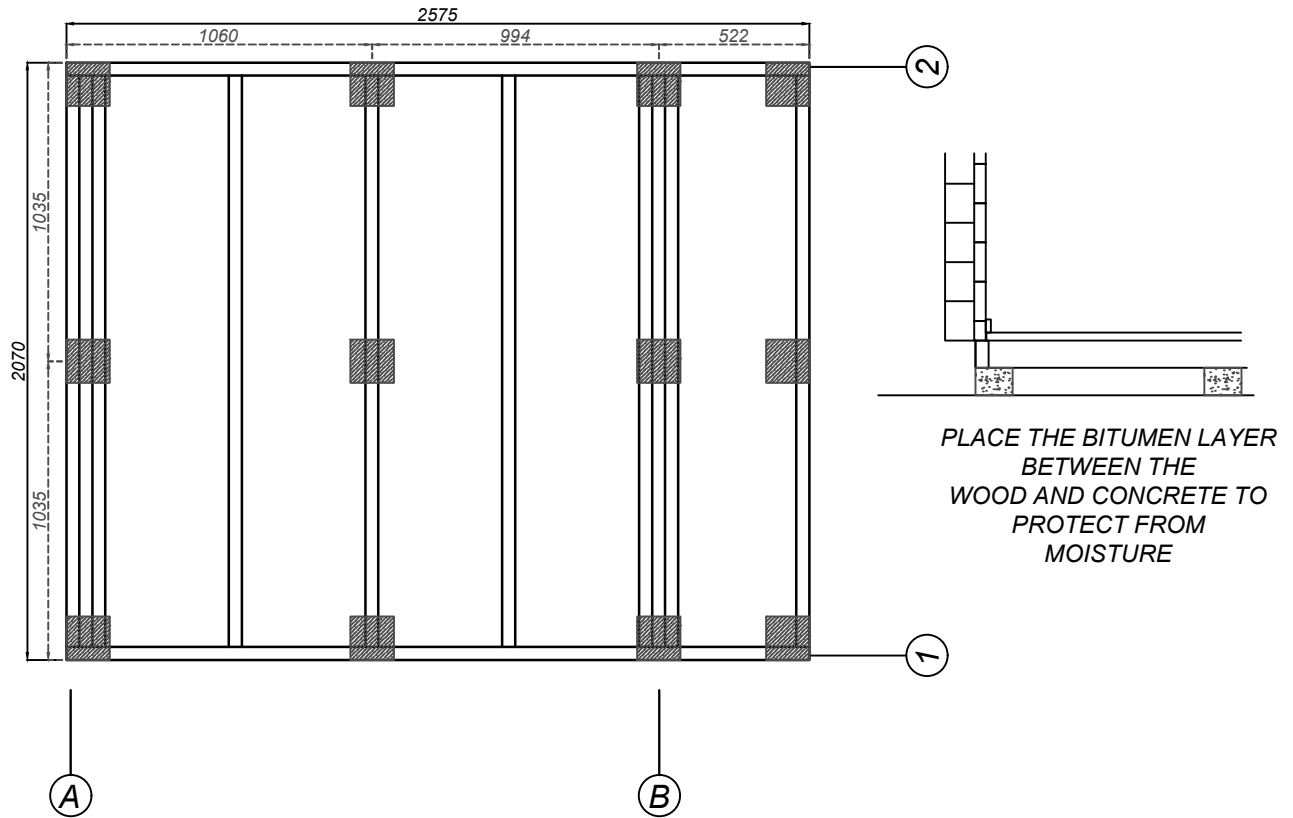

OPTION B

WHEN USING AN EXTRA BEAMS UNDER THE FLOOR FRAME -
AMOUNT OF SUPPORTS CAN BE REDUCED
(NOT INCLUDED WITH DELIVERY KIT)

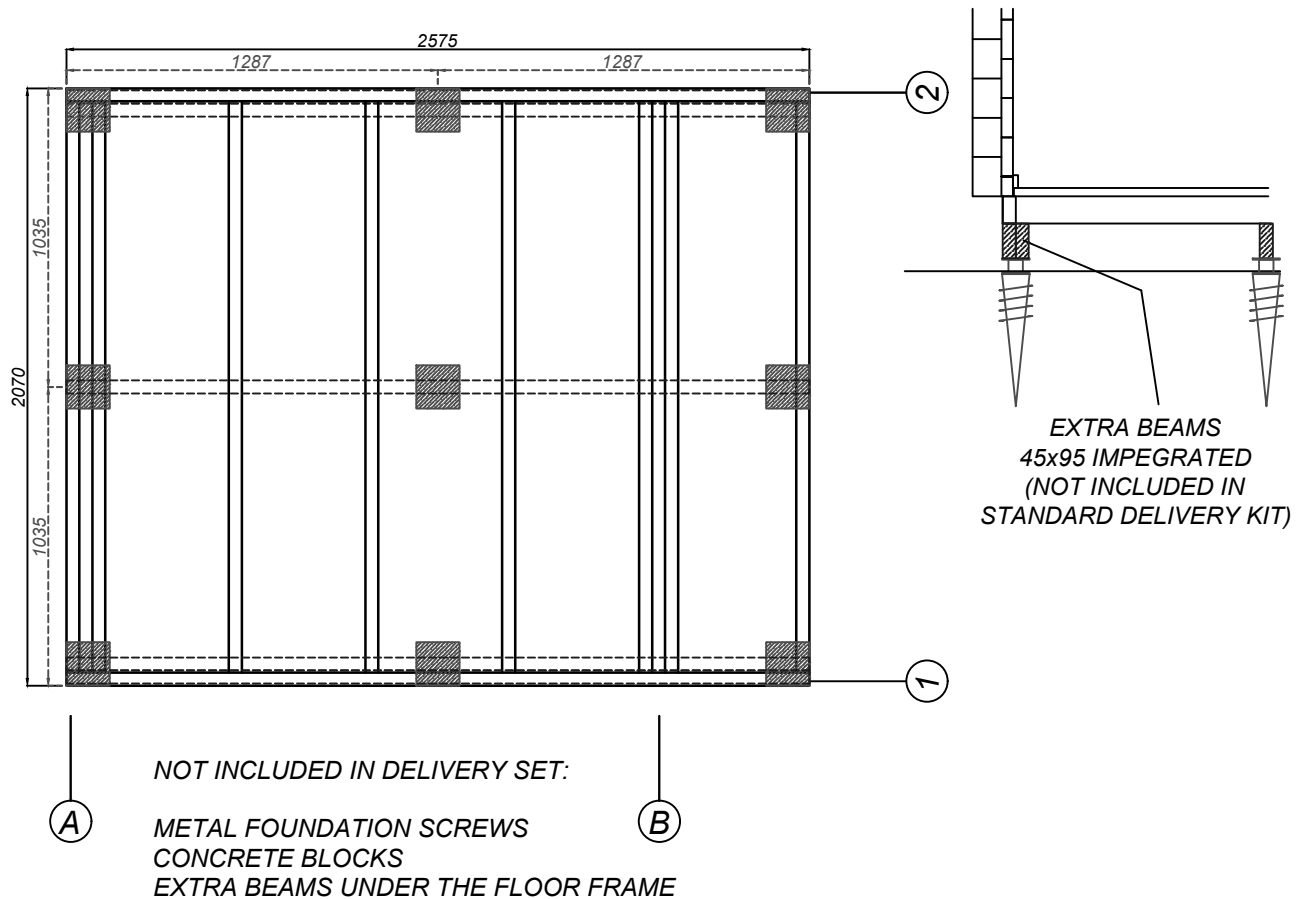

FLOOR FRAME 45x95

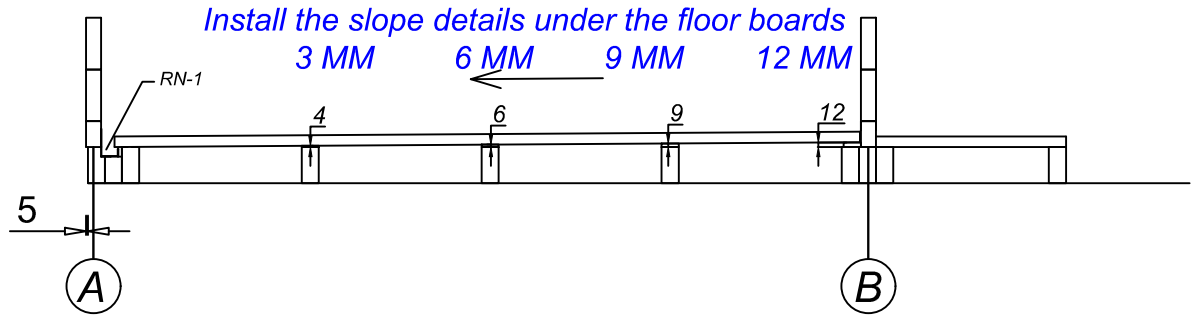

AR-3 CROSS-SECTION

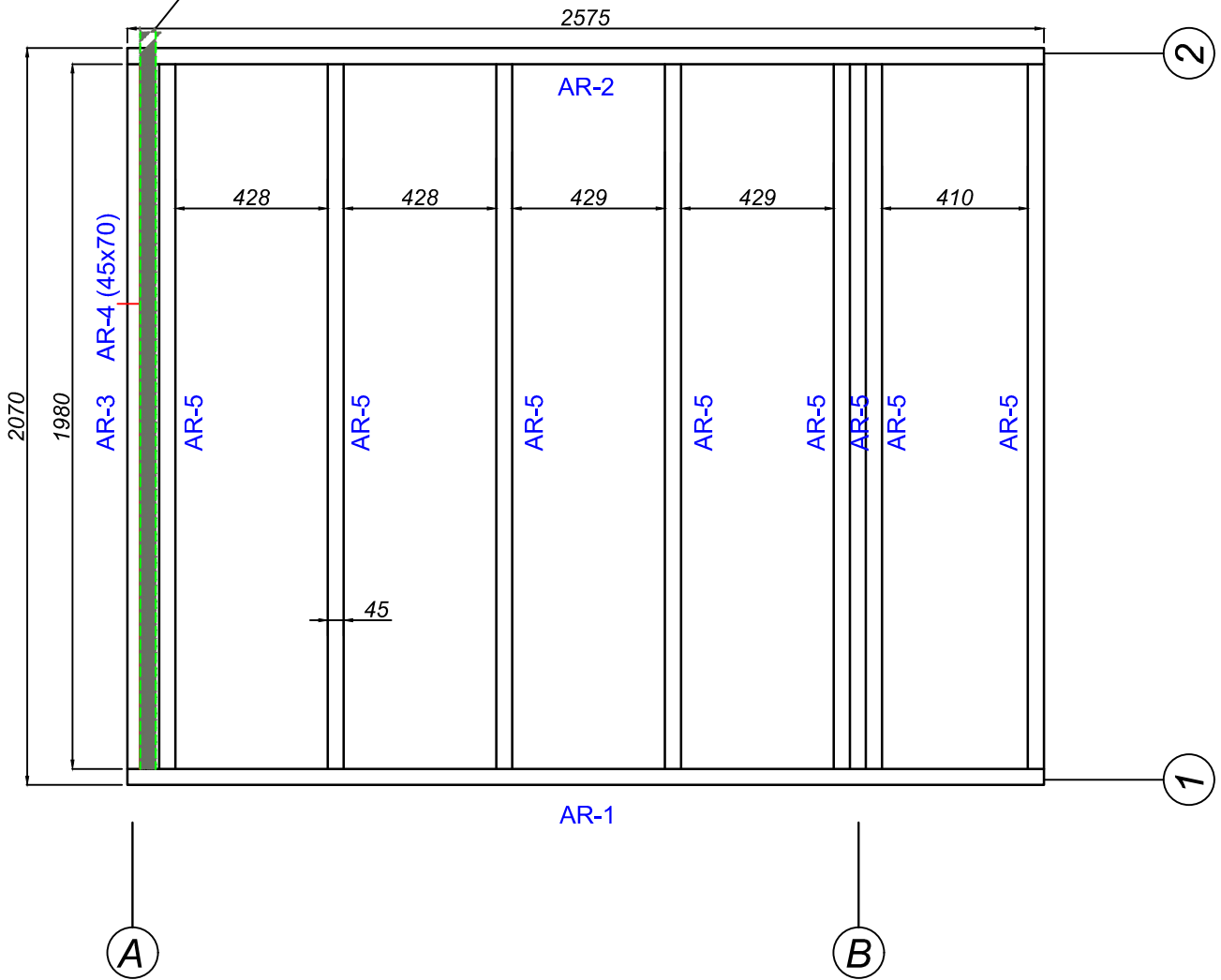
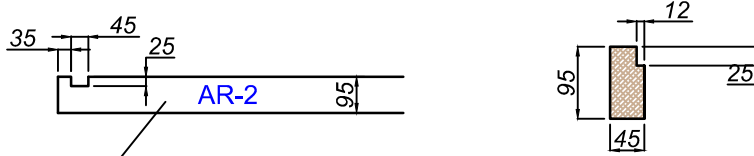

FLOOR FRAME

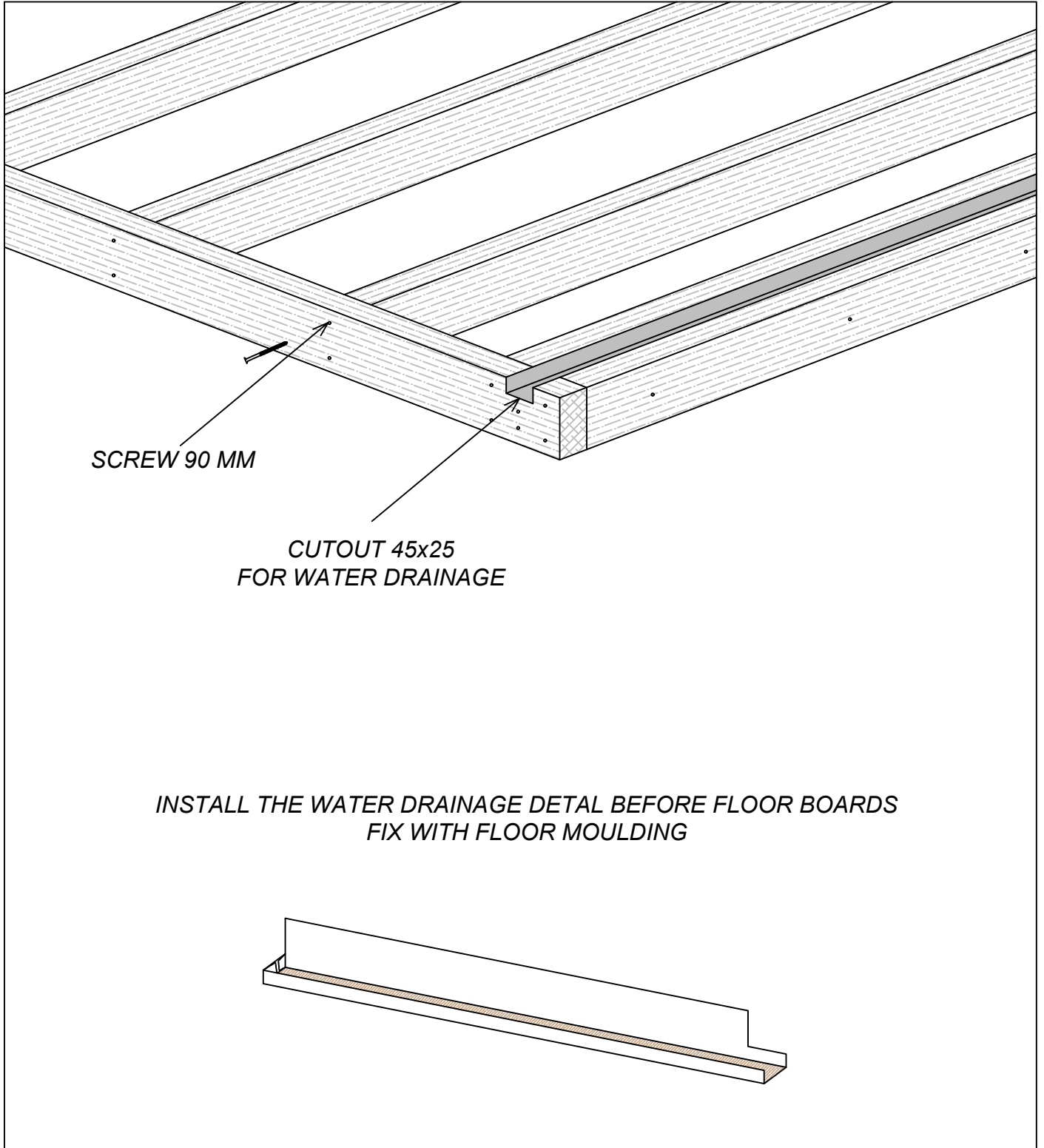

FLOOR BOARDS AND DECKING BOARDS

Cut the floor boards to length 1960 mm or use as end joint
(using the leftover to start the next row)

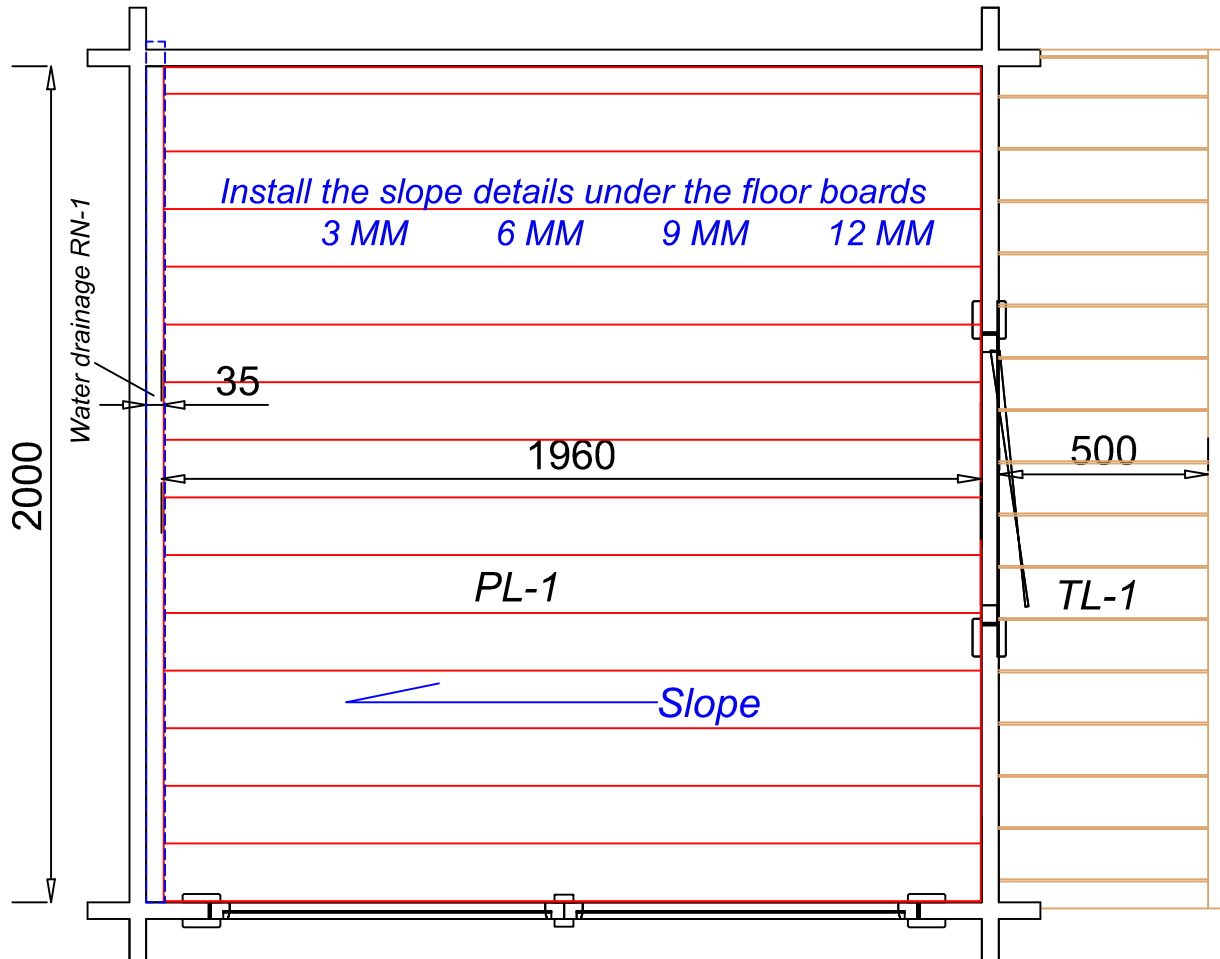

BEFORE THE FLOOR BOARD, INSTALL FLOOR SLOPE DETAILS

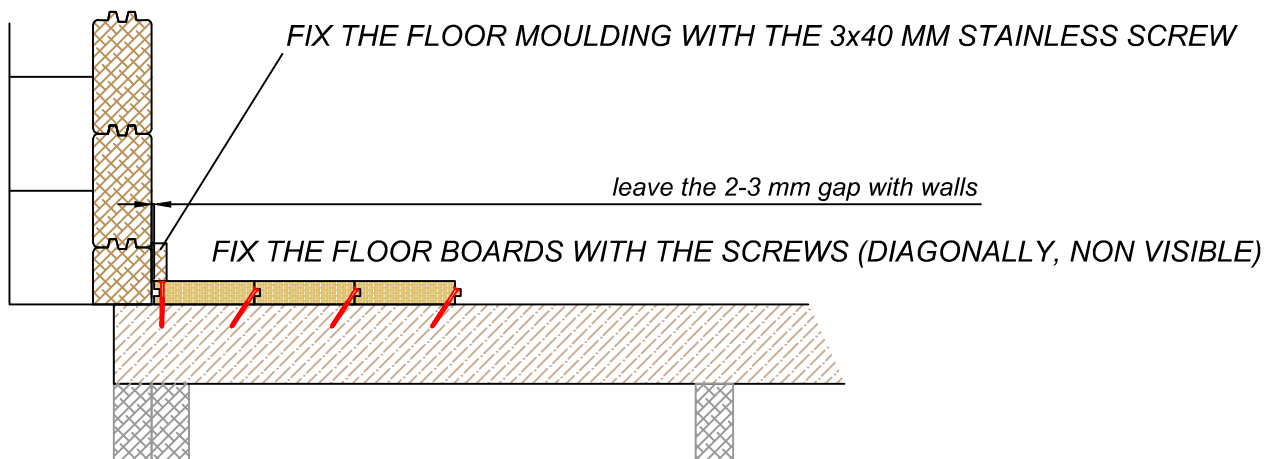

FIRST ROW

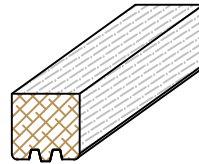
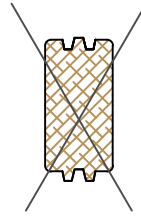

Use rubber hammer and hammer block

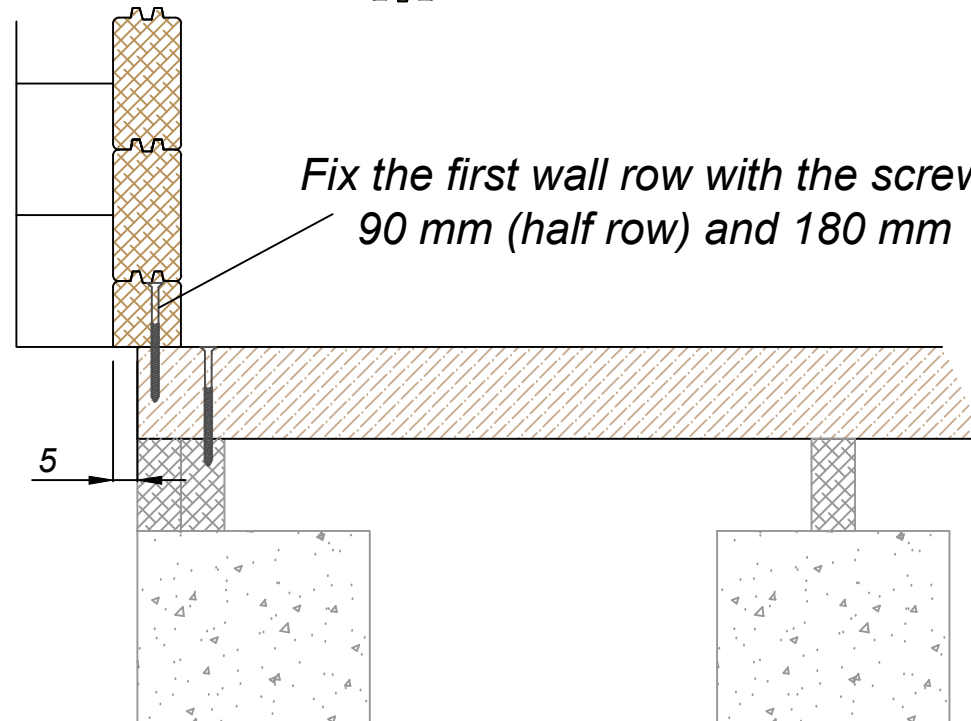

**IN EACH CONNECTION USE 90 MM STAINLESS SCREWS
(TO PROTECT THE BUILDING FOR WIND)**



WALL 1

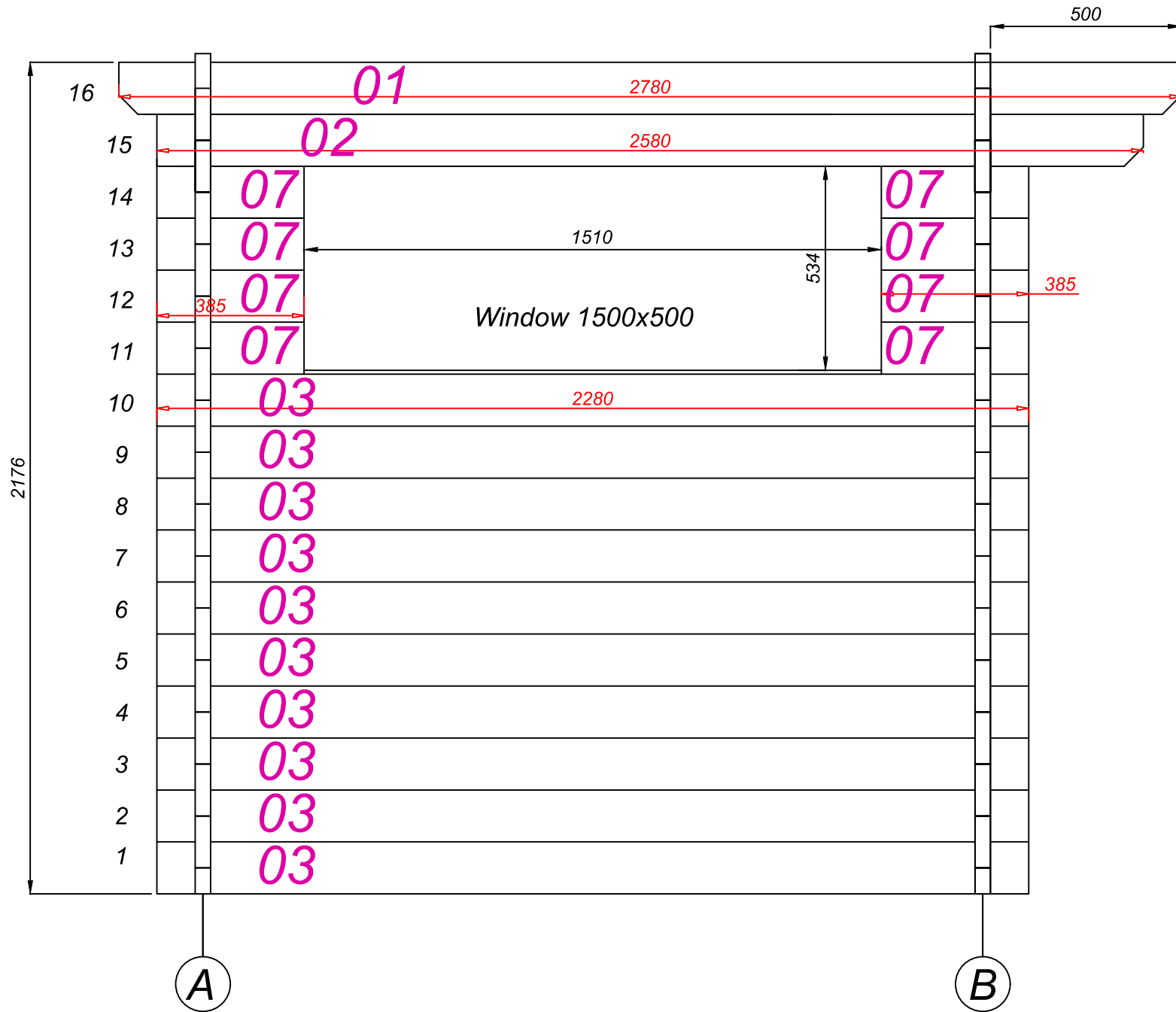

WALL 2

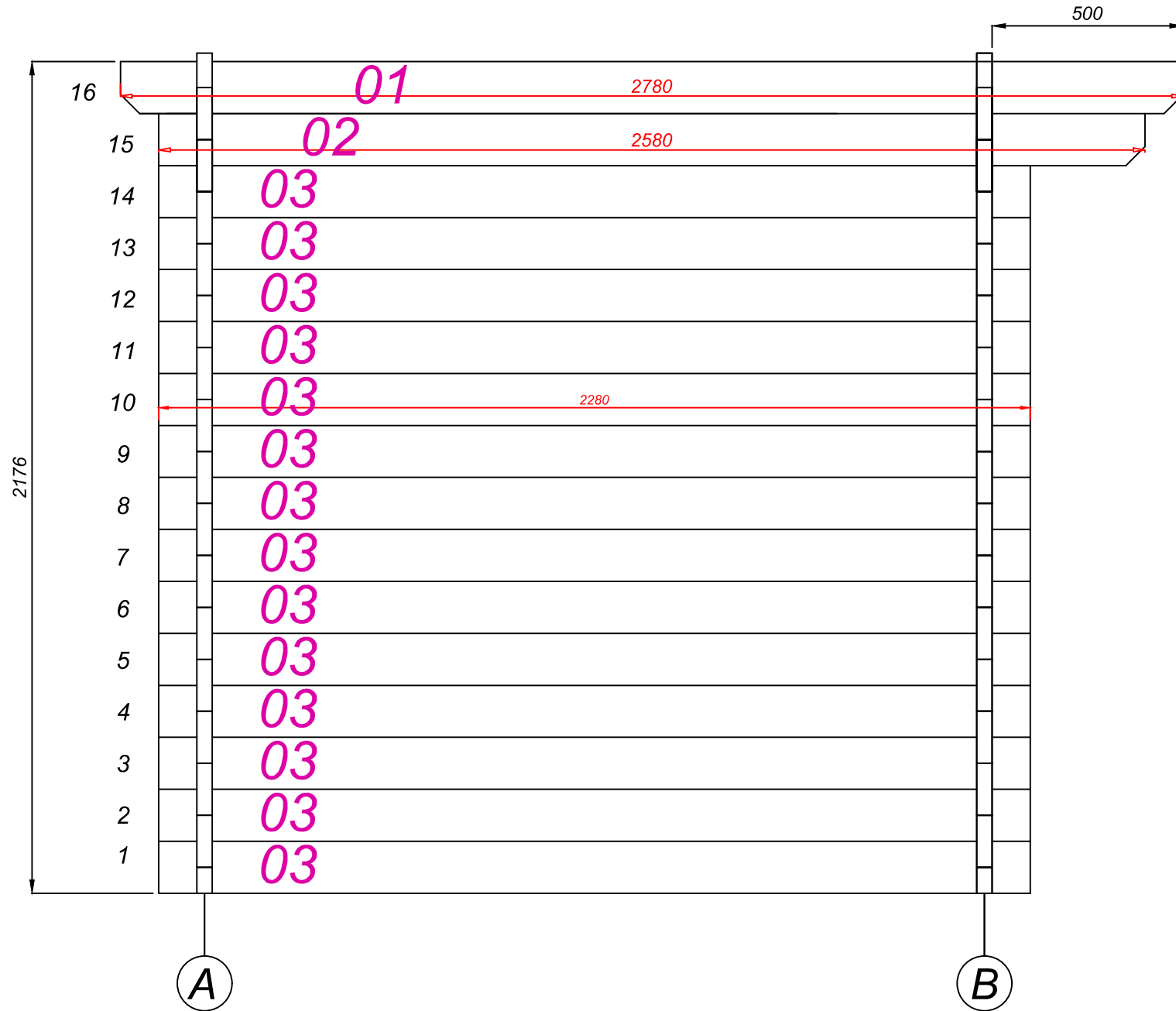

WALL A

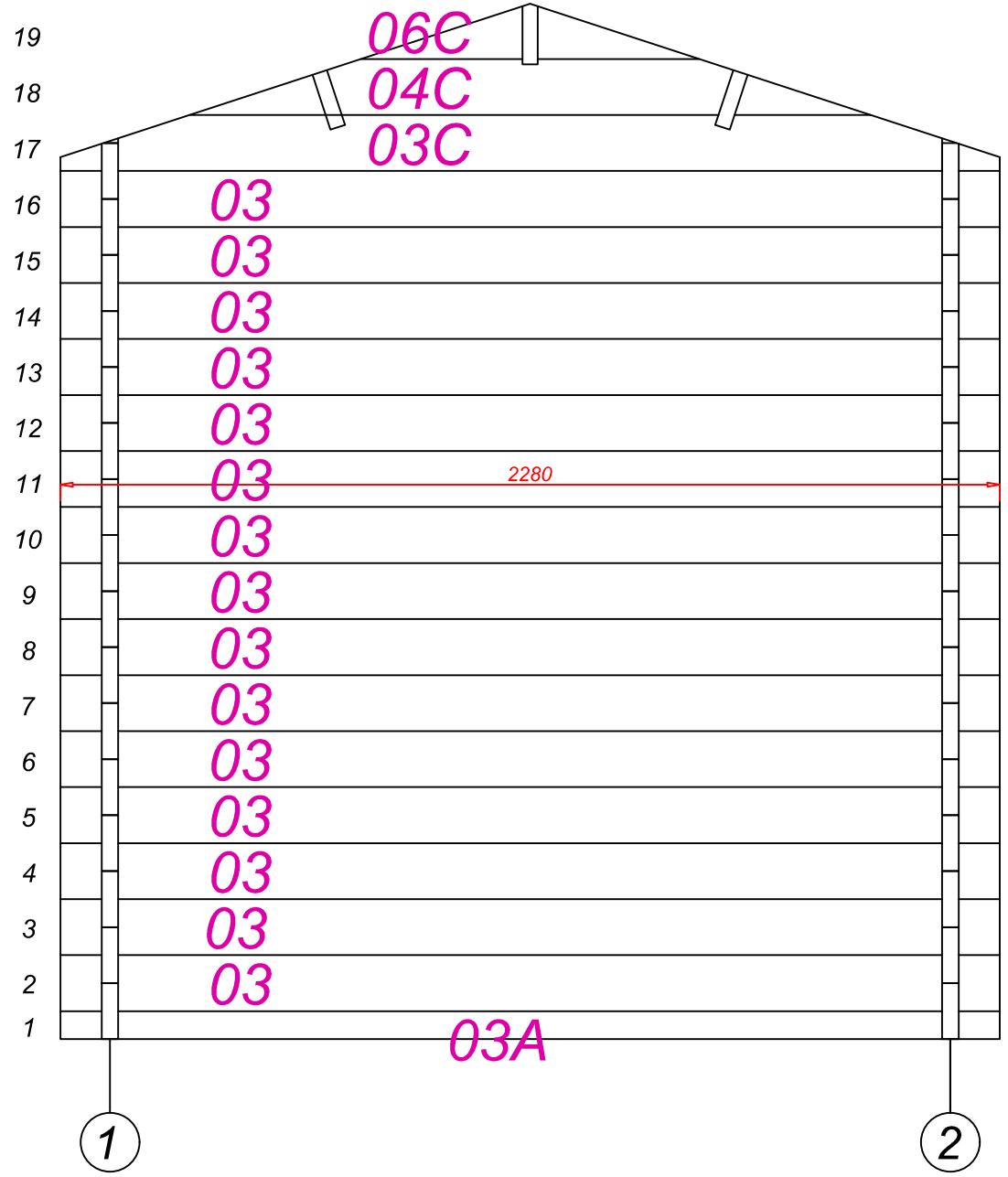

WALL B

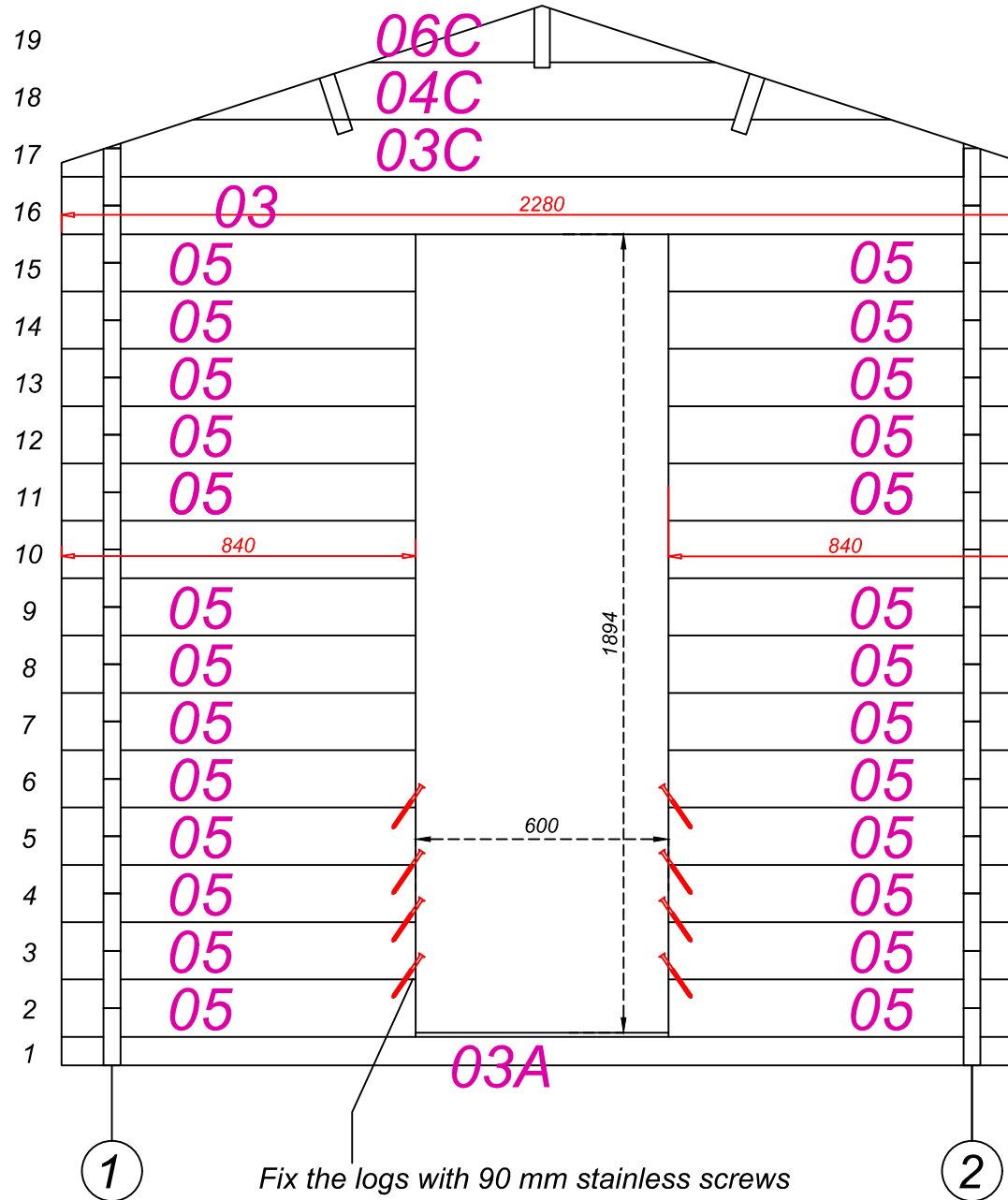

RAFTER PLAN

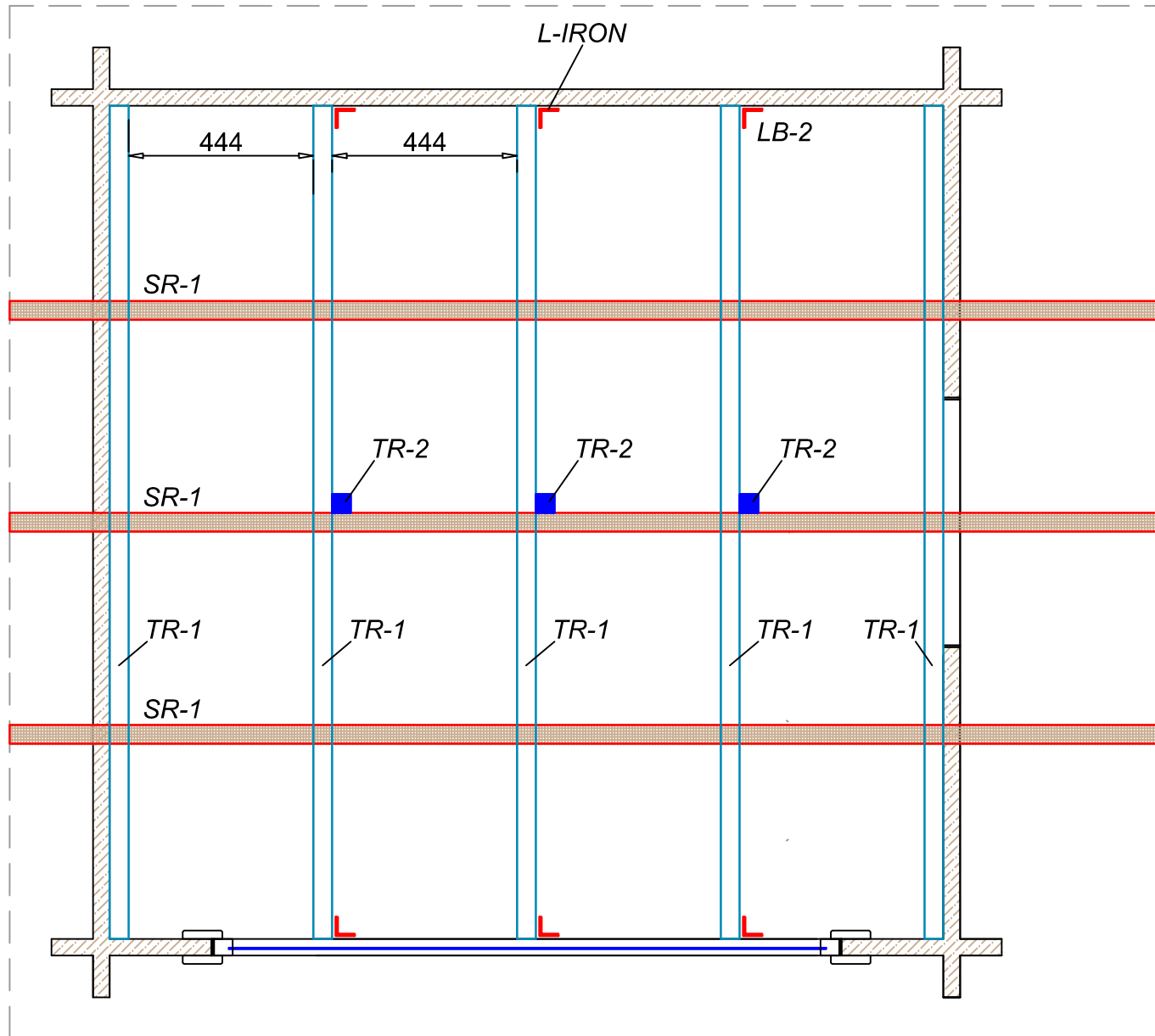

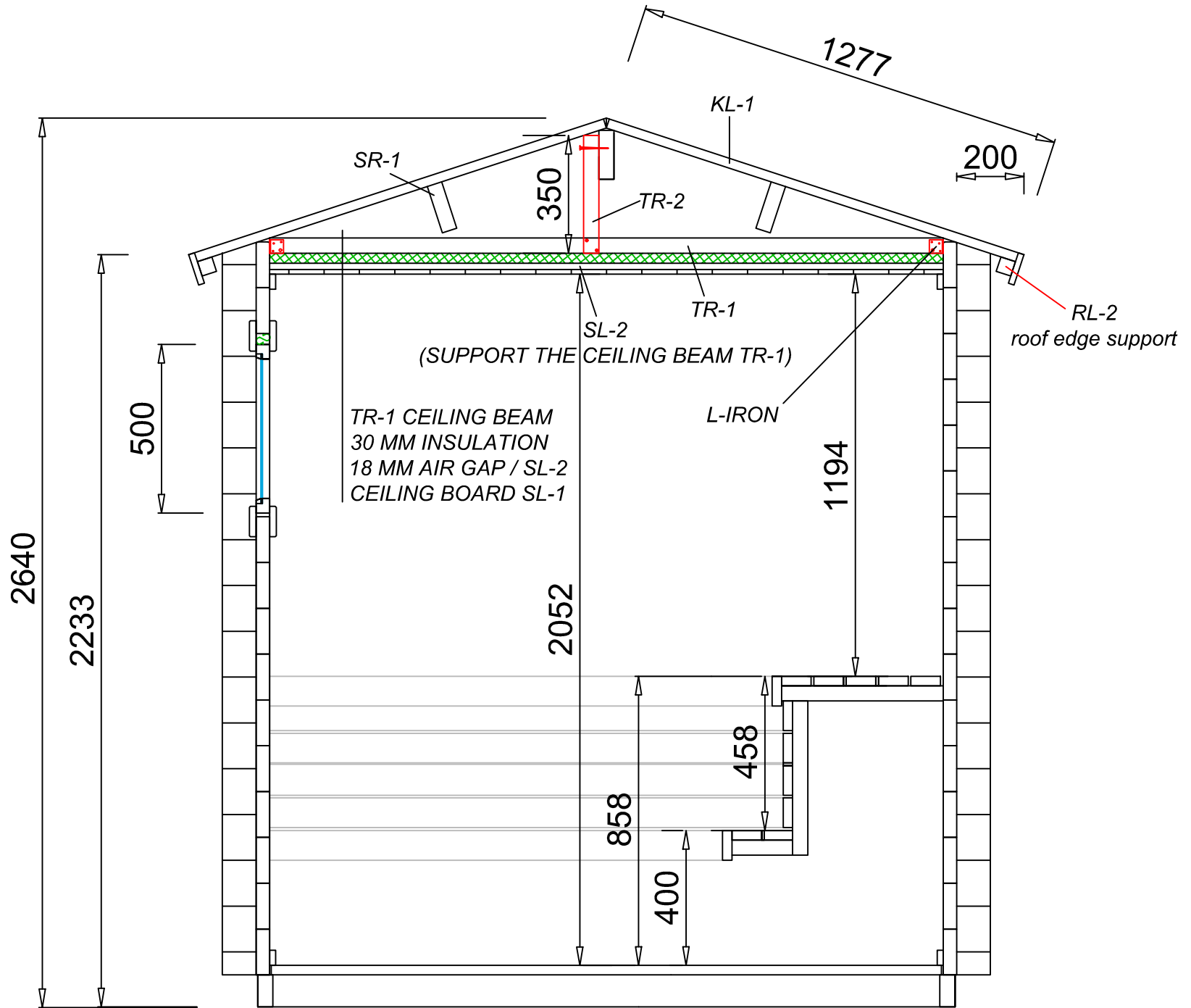

ROOF RAFTER SR-1 - 3 pcs

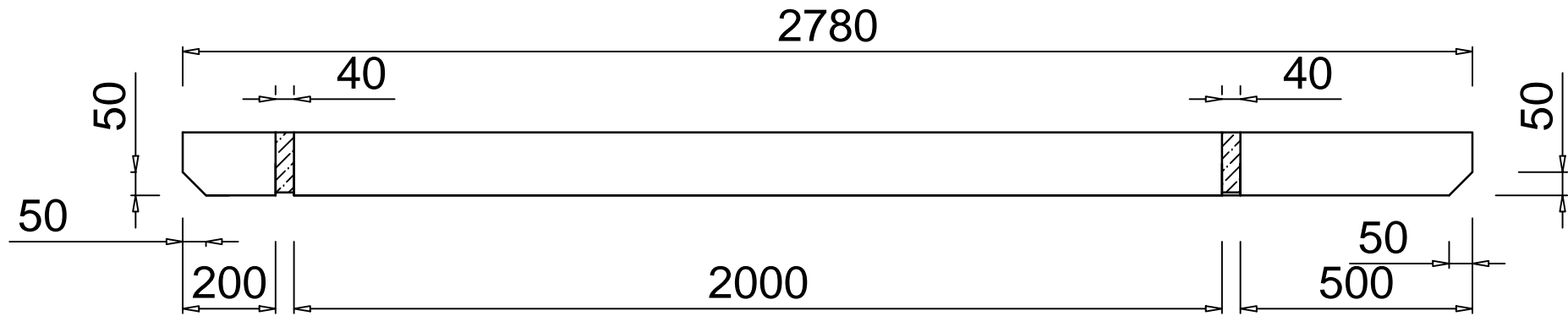

WINDOW MOULDINGS 18x95

OUTSIDE AND INSIDE MOULDINGS ARE WITH THE SAME LENGTH
FIX WITH A 40 MM STAINLESS SCREWS

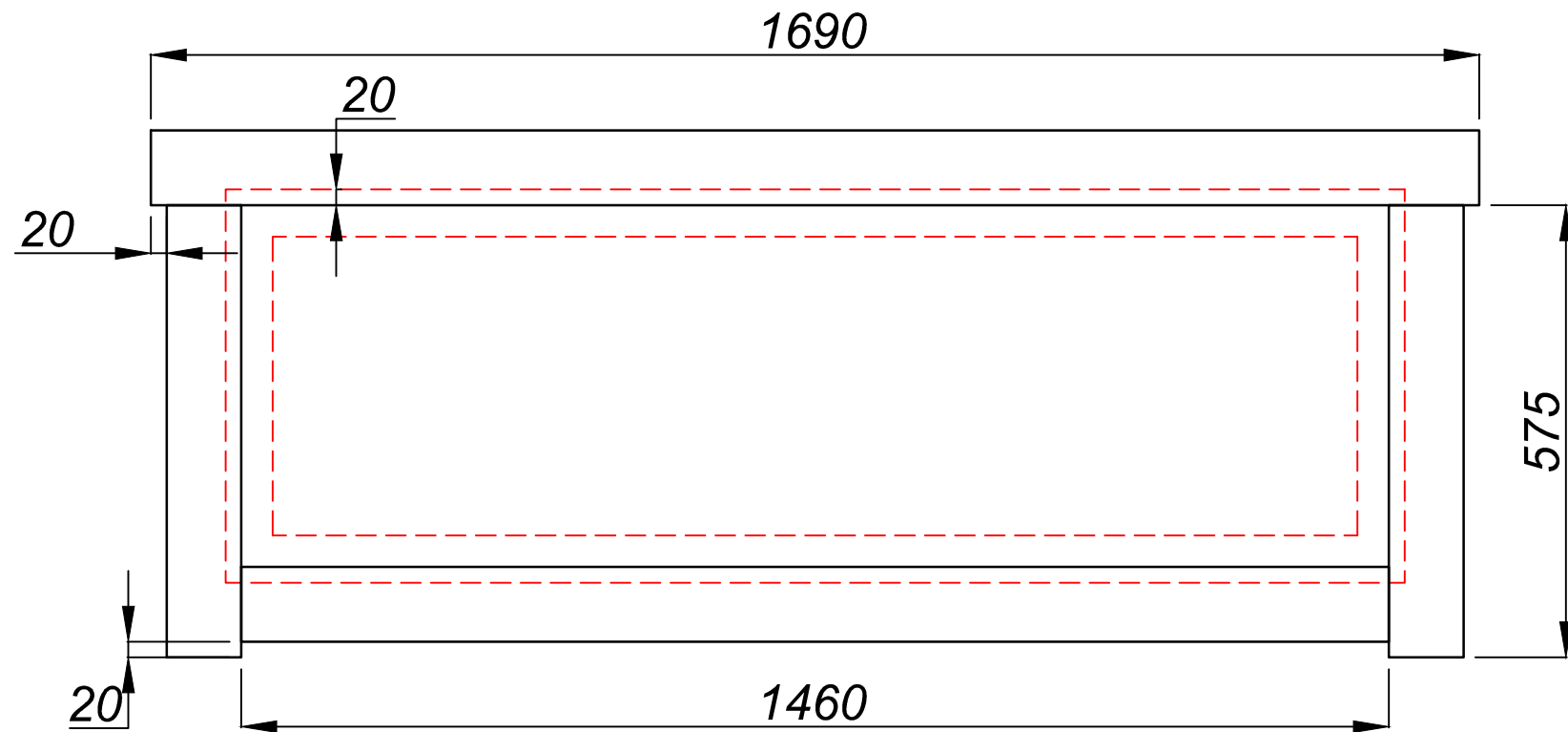

BENCH SET

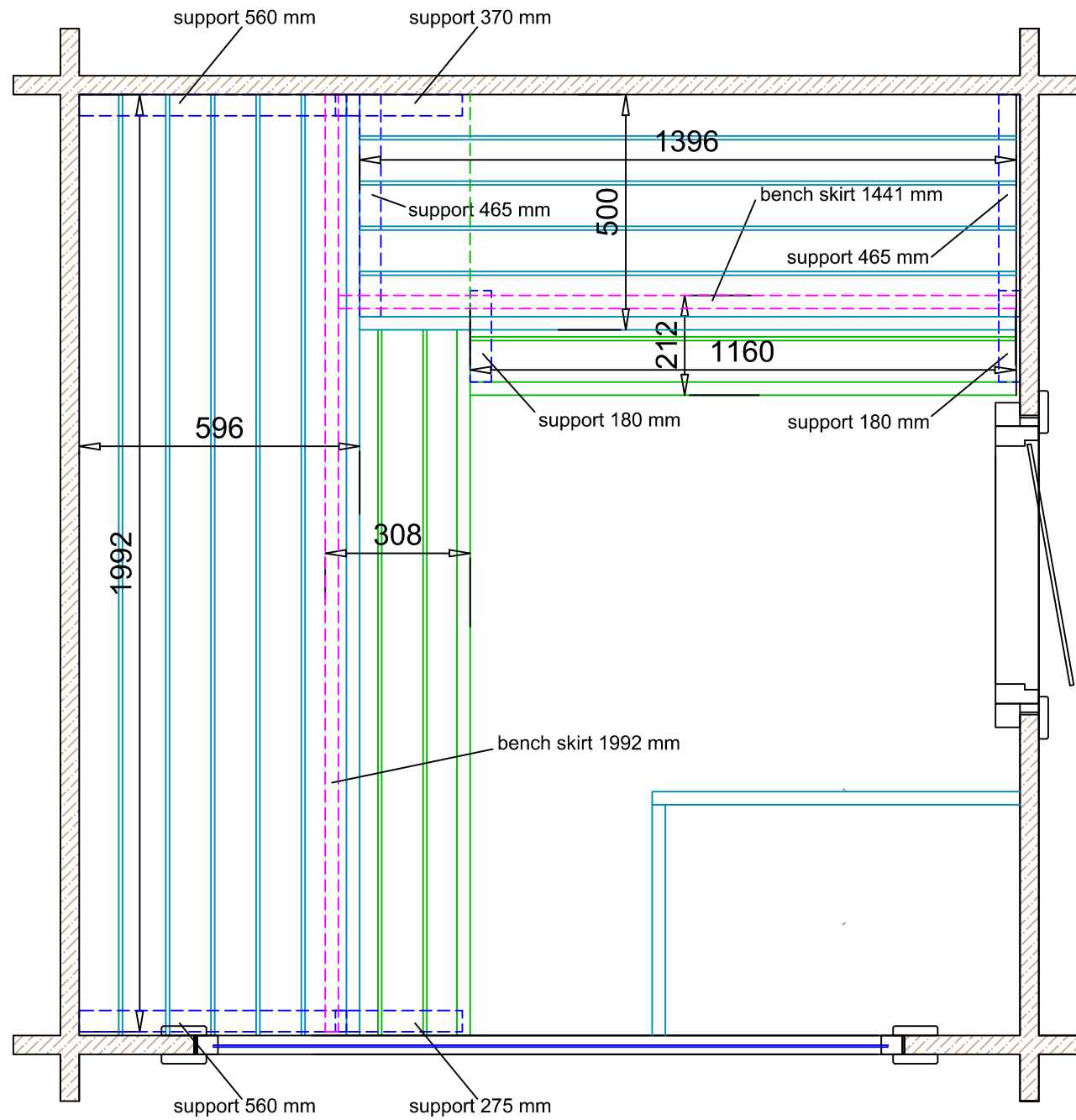

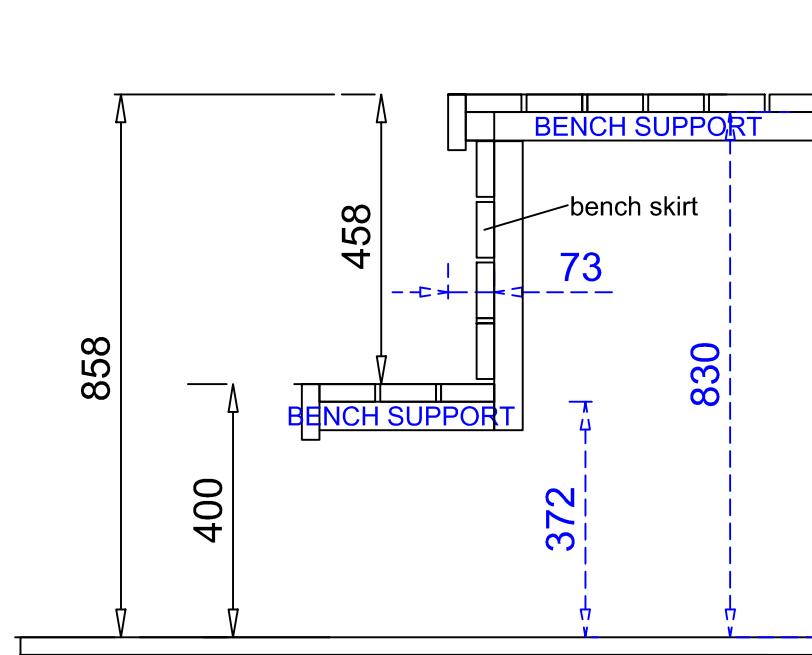

1. FIRST FIX THE BENCH SUPPORTS TO THE WALL
2. THEN LIFT THE BENCHES ON TOP OF THEM
3. FIX THE BENCHES WITH THE 70 MM SCREWS TO THE WALLS AND SUPPORTS
4. USE VERTICAL SUPPORT TO SUPPORT THE BENCH FROM THE MIDDLE